

River Courses Beginning at a post on Little Conyaut—

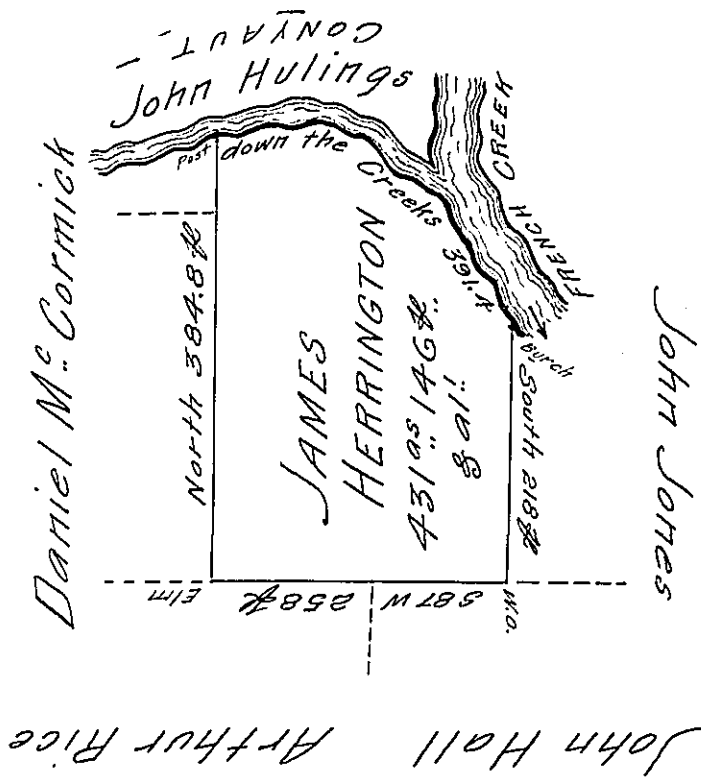

S 66 E 31 #
S 78 1/2 E 24
N 76 E 6
S 53 E 20
S 18 3/4 E 12.6
S 30 1/2 E 12.5
S 20 3/4 E 12.2
N 35 3/4 E 23.7
N 56 1/4 E 6.4
S 79 1/4 E 6
South 5
S 7 E 43
S 20 3/4 E 30
S 26 3/4 E 20
S 46 3/4 E 20
S 49 1/4 E 6.2
S 63 3/4 E 10
S 88 1/4 E 20
S 84 3/4 E 16
N 89 1/2 E 14
N 86 3/4 E 5
N 76 3/4 E 7.8
N 82 1/2 E 40
<u>391.4 #</u>

Situate on the West side of French Creek
 In Allegheny County Containing 431 90 146 # and al-
 lowance of six # Cent for Roads &c Surveyed
 the 29th day of May 1795 In pursuance of his
 Improvement Bearing date the 6th day of May
 1793.

W^m Power D^y. Sr.

To Daniel Brodhead Esq^r. }
 Surveyor General }

IN TESTIMONY that the above is a copy of the original remaining on file in
 the Department of Internal Affairs of Pennsylvania, made
 conformably to an Act of Assembly approved the 16th day of
 February, 1833, I have hereunto set my Hand and caused
 the Seal of said Department to be affixed at Harrisburg,
 this Seventh day of August 1906

Guac R. Jones
 Secretary of Internal Affairs.